



REHAU TOTAL70c WINDOW AND DOOR SYSTEM

CHAMFERED PROFILE PRINT

REHAU TOTAL70c

PROFILE PRINT

The following profile print shows PVC-U main profiles, glazing beads and steel reinforcement profiles dedicated to the REHAU TOTAL70c Window and Door system.

Each item is identified by at least one Article No., many have two Article Nos. The first Article No. identifies the basic item, the second identifies the laminated item.

A 3 digit Variant No. after the Article No. then denotes standard packaging and colour options:

Key to variant system.

701	Individual packs	White profile/beads with Black co-ex gasket
705	Individual packs	White profile/beads with White co-ex gasket
901	Stillage	White profile
751	Individual packs	Mahogany foil both faces on Brown base profile/beads with Black co-ex gasket
721	Individual packs	Mahogany foil to Face A on White base profile
761	Individual packs	Mahogany foil to Face B on White base profile
790	Individual packs	Golden Oak foil beads with Black co-ex gasket
351	Individual packs	Golden Oak foil on both faces on Acorn base
321	Individual packs	Golden Oak foil to Face A on a White base profile
361	Individual packs	Golden Oak foil to Face B on a White base profile
251	Individual packs	Rosewood foil both faces on Brown base profile/beads with Black co-ex gasket
221	Individual packs	Rosewood foil to Face A on White base profile
261	Individual packs	Rosewood foil to Face B on White base profile
Other Variants	Various items	Other variants do not necessarily follow a set pattern. See relevant section of this profile print for exact description.

Where profiles are symmetrical there is no need to distinguish between faces, therefore only variant 721, 221 or 321 is needed. Please refer to ordering guide for standard lengths, pack quantities and confirmation of Article Nos & Variant Nos together with standard/non standard status.

*** DENOTES AVAILABLE AS A SPECIAL ORDER - NOT A STANDARD STOCK ITEM - PLEASE REFER TO SALES OFFICES FOR MINIMUM QUANTITIES, LEAD TIMES AND PRICES.**

REHAU TOTAL70c

OUTER FRAMES

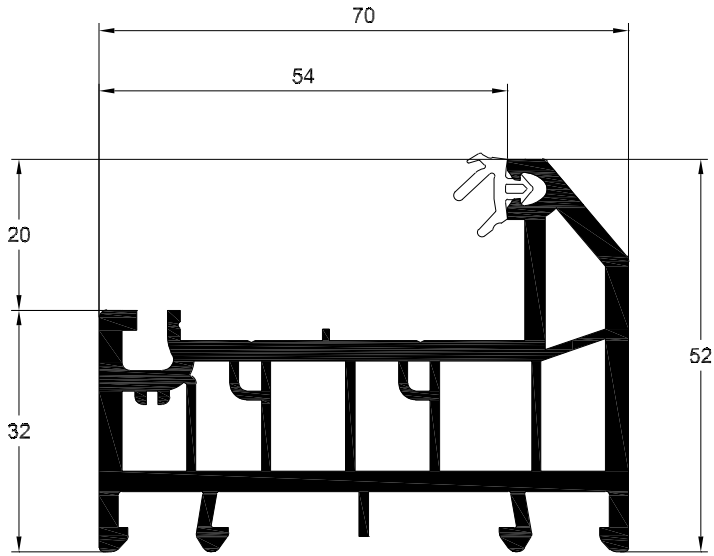

Casement Slim Outer Frame 52mm (6 Chamber)
White Profile Art. No. 546845

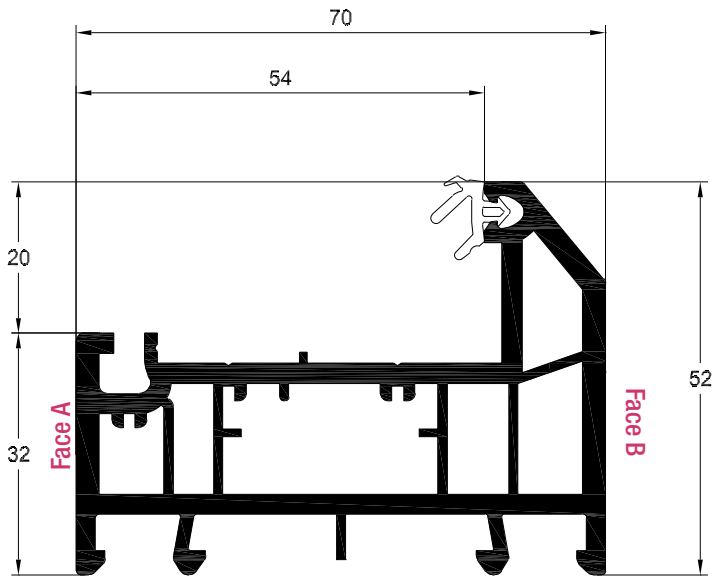

Casement Slim Outer Frame 52mm (5 Chamber)
White Profile Art. No. 546815
Laminated Profile Art. No. 586815

	216391
	1.5mm
ix	0.61
ly	0.17

216391 - 25 x 11

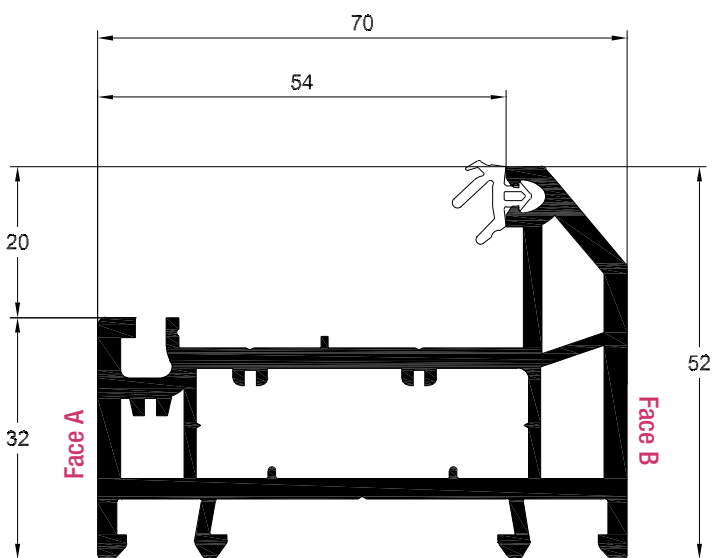
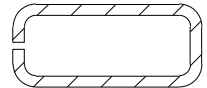

Casement Slim Outer Frame 52mm
White Profile Art. No. 546075
Laminated Profile Art. No. 576255

	261748	249838	261948
	2mm	1mm	Aluminium
ix	3.06	1.77	4.18
ly	0.27	0.14	0.3

261748 - 42 x 10

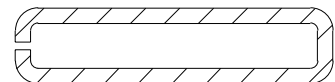

249838 - 42 x 10

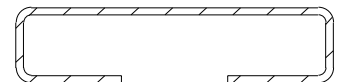

261948 - 42 x 10



REHAU TOTAL70c

OUTER FRAMES

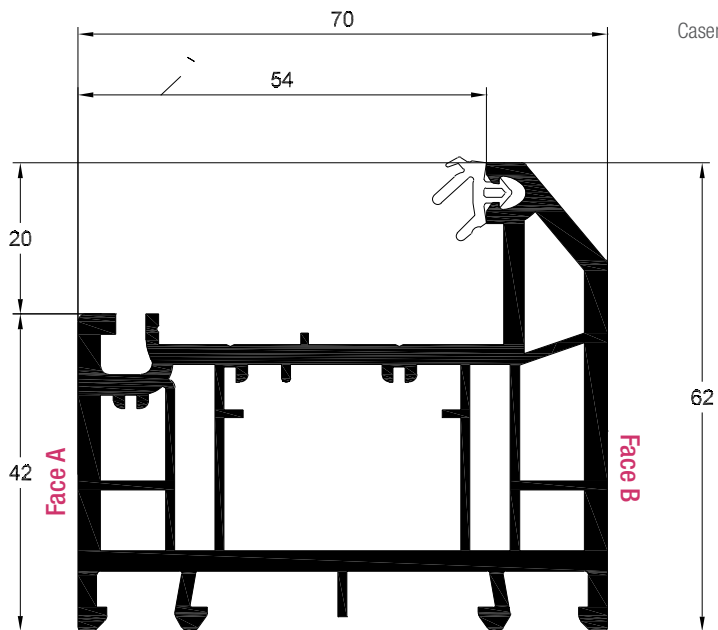

Casement Intermediate Outer Frame 62mm (5 Chamber)

White Profile Art. No. 546825

Laminated Profile Art. No. 586825

	216392
	1.5mm
lx	1.03
ly	0.80

216392 - 25 x 21

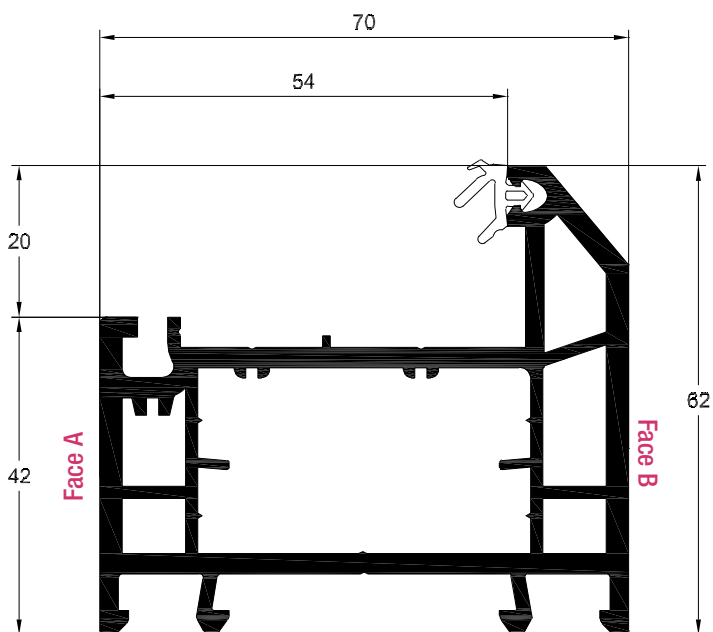
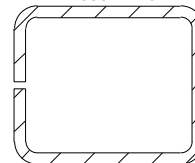

Casement Intermediate Outer Frame 62mm

White Profile Art. No. 546605

Laminated Profile Art. No. 576286

	261748	249838	232822
	2mm	1mm	2mm
lx	3.06	1.77	2.34
ly	0.27	0.14	0.07

261748 - 42 x 10

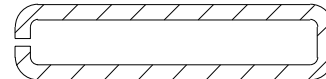

249838 - 42 x 10

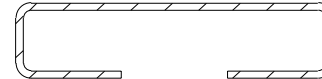

232822 - 42 x 9.8



REHAU TOTAL70c

OUTER FRAMES

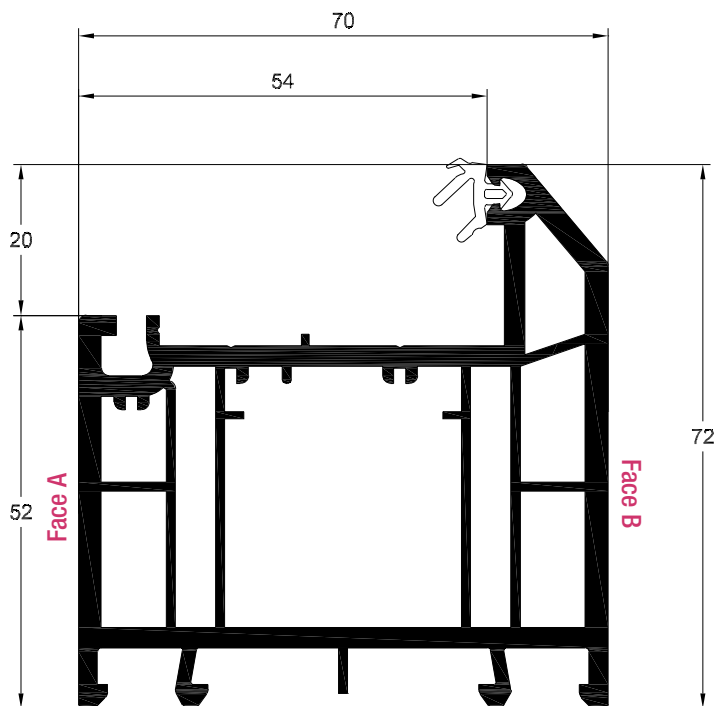

Casement Universal Outer Frame 72mm (5 Chamber)

White Profile Art. No. 546835

Laminated Profile Art. No. 586835

	216393
	1.5mm
lx	1.44
ly	2.0

216393 - 25 x 31

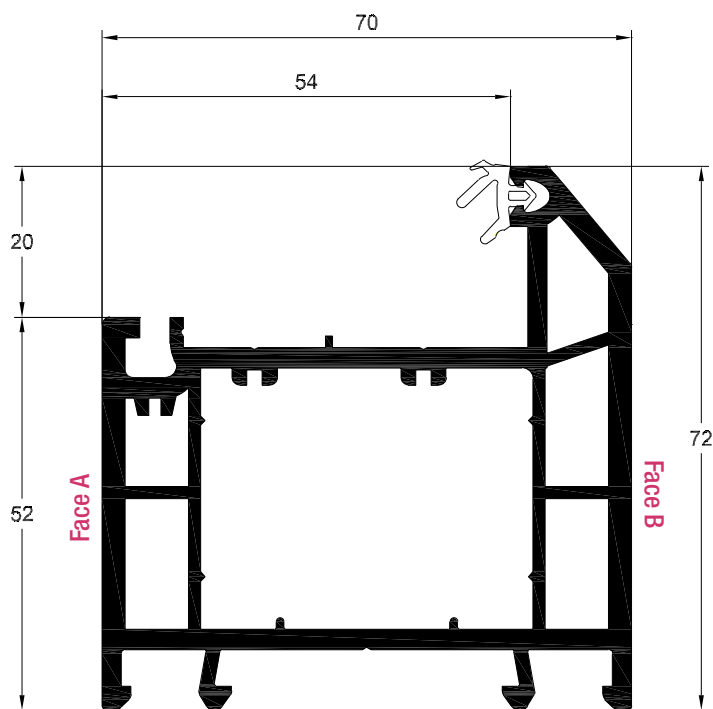
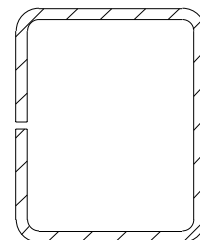

Casement Universal Outer Frame 72mm

White Profile Art. No. 546185

Laminated Profile Art. No. 576365

	261958	249848	200327
	1.5mm	1mm	1.5mm
lx	4.87	3.45	3.98
ly	2.93	1.75	2.56

261958 - 42 x 30

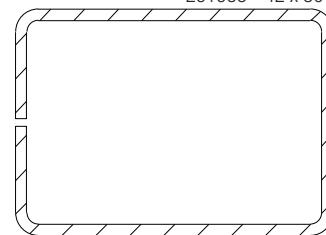

249848 - 42 x 30

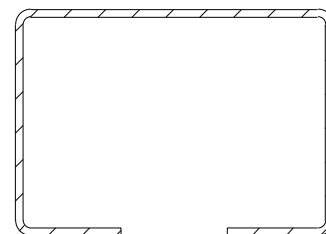

200327 - 42 x 30 x 30 x 18

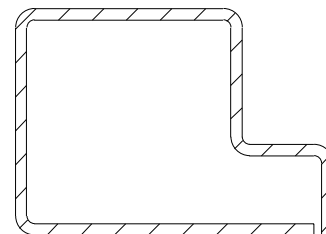

REHAU TOTAL70c

CASEMENT SASHES

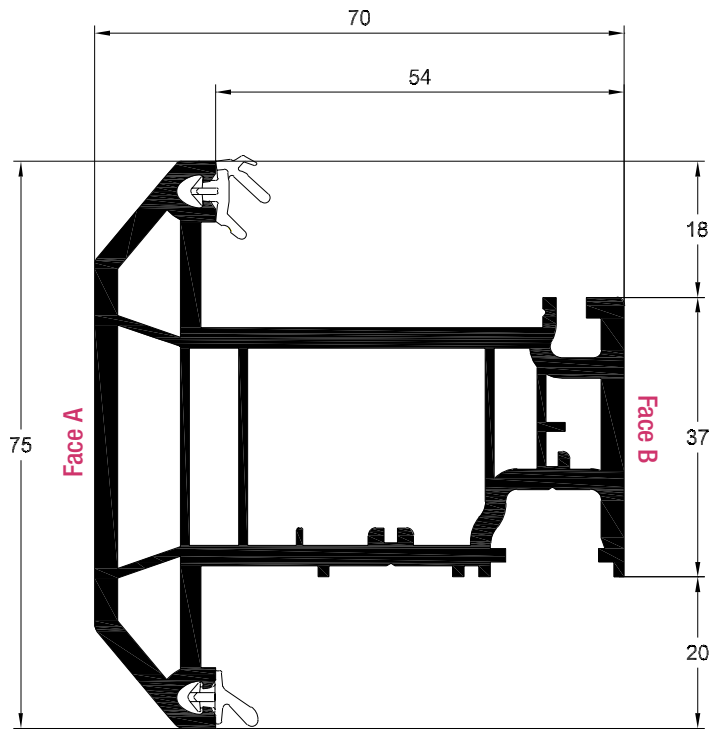

Casement T Sash 75mm (5 chamber)
 White Profile Art. No. 546855
 Laminated Profile Art. No. 586855

	216394
	1.5mm
ix	1.47
ly	1.1

216394 - 30 x 23

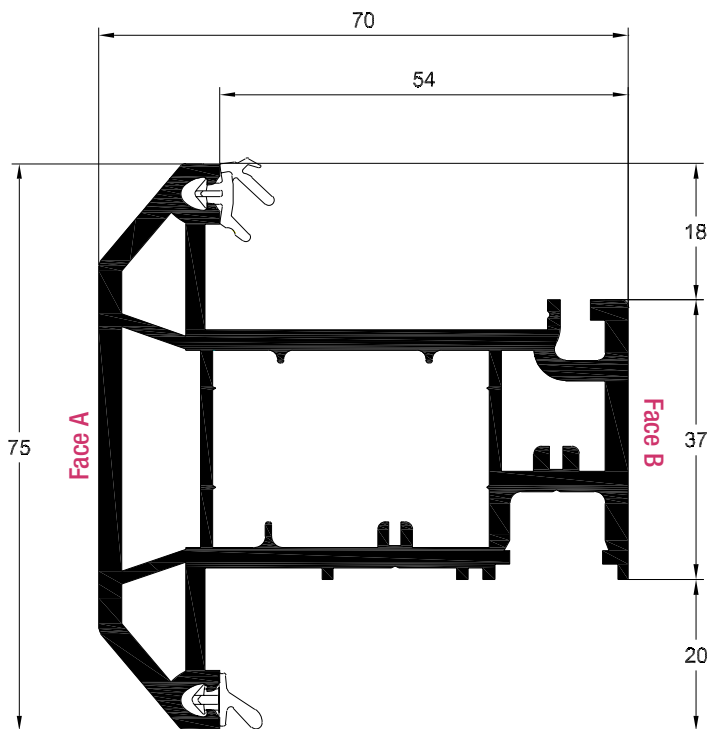
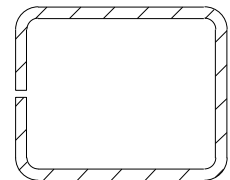

Casement T Sash 75mm
 White Profile Art. No. 546106
 Laminated Profile Art. No. 576287

	261968*	287777
	1.5mm	1mm
ix	2.15	1.65
ly	0.77	0.58

261968* - 20 x 35 x 20 x 19

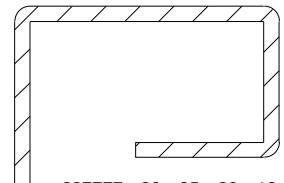

287777 - 20 x 35 x 20 x 19

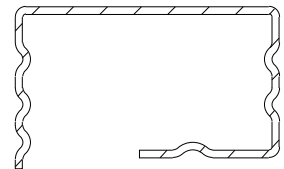

*Special order (allows for maximum sizes to be achieved)

REHAU TOTAL70c

CASEMENT SASHES

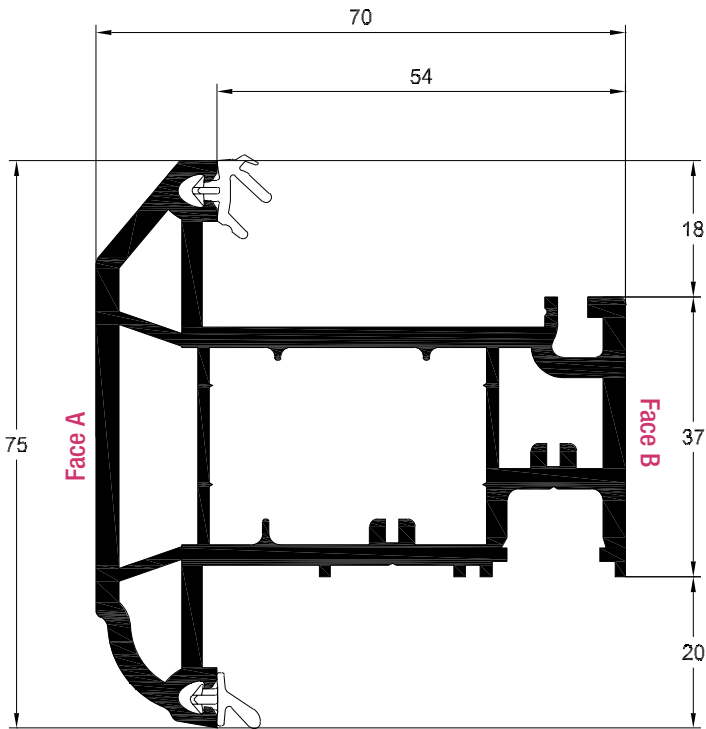

Part Sculptured Casement T Sash 75mm
 White Profile Art. No. 546586
 Laminated Profile Art. No. 576267

	261968*	287777
	1.5mm	1mm
lx	2.15	1.65
ly	0.77	0.58

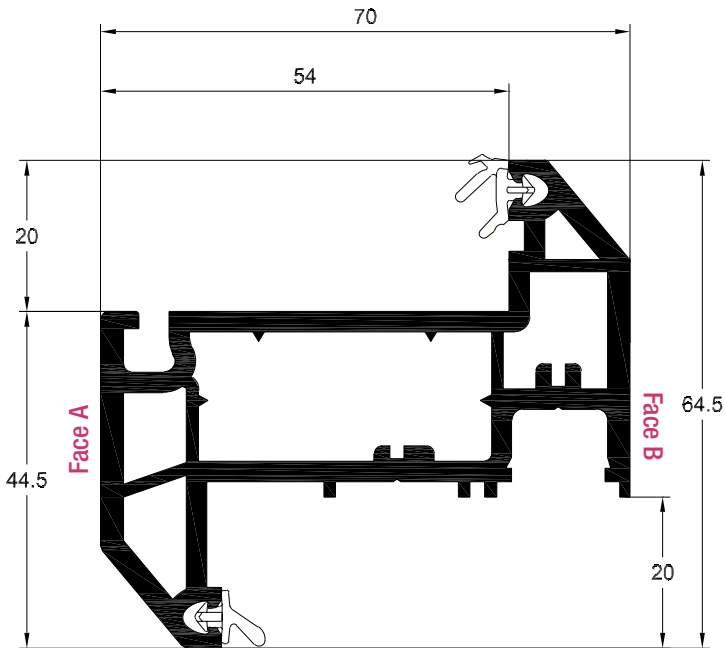
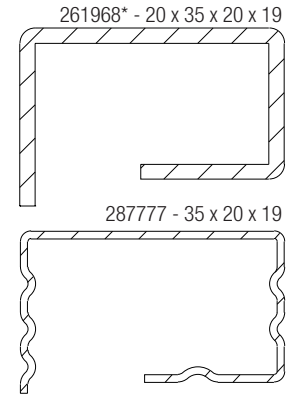

Casement Z Sash
 White Profile Art. No. 546066
 Laminated Profile Art. No. 576247

	261938*	287786
	1.5mm	1mm
lx	1.66	1.26
ly	0.29	0.24

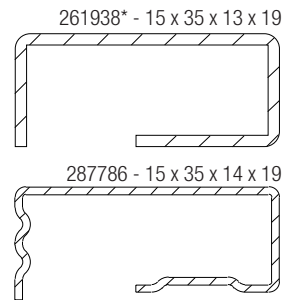

*Special order (allows for maximum sizes to be achieved)

REHAU TOTAL70c

TILT AND TURN SASH

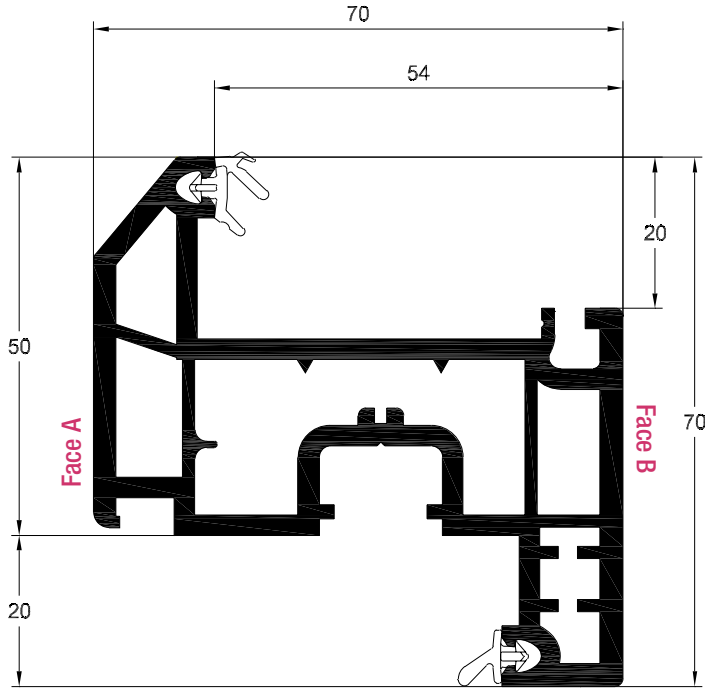

Tilt and Turn Sash 70mm
 White Profile Art. No. 546776
 Laminated Profile Art. No. 576776

	287779
	1mm
lx	1.91
ly	0.23

287779 - 18 x 40 x 18

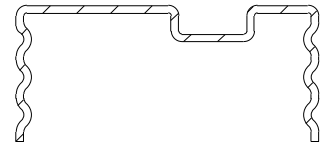

DOOR OUTER FRAME

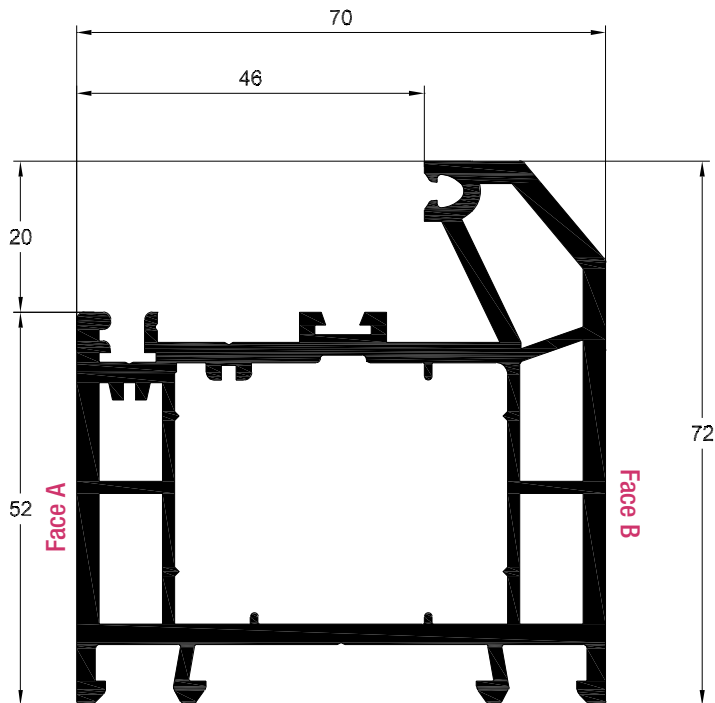

Composite Door Outer Frame
 White Profile Art. No. 546760
 Laminated Profile Art. No. 576761

	261958	200022
	1.5mm	2mm
lx	4.87	2.67
ly	2.93	3.30

261958 - 42 x 30

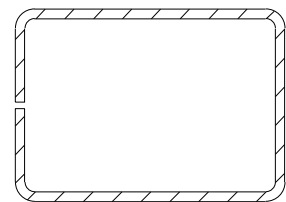

200022 - 30 x 23 x 17 x 16 x 35

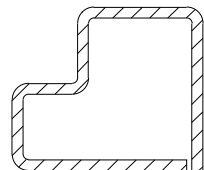

Gasket - 864610



REHAU TOTAL70c

DOOR SASHES

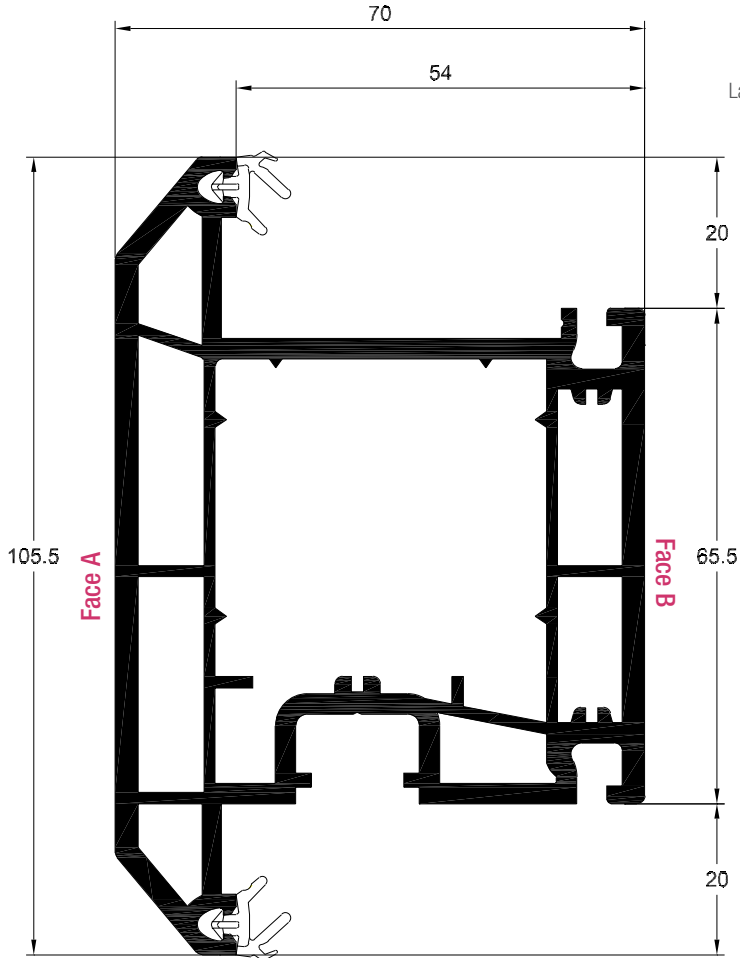

Door T Sash / Midrail 105.5mm
 White Profile Art. No. 546635
 Laminated Profile Art. No. 576635

The same steels apply to both the T and Z Door Sashes

	252827	287787	258841	200374
	2mm	1mm	2mm	1.5mm
lx	6.60	3.75	7.21	5.64
ly	4.80	2.57	7.21	5.64

252827 - 40 x 40 x 40 x 12

Pre-routed 262490 - 40 x 40 x 40 x 12

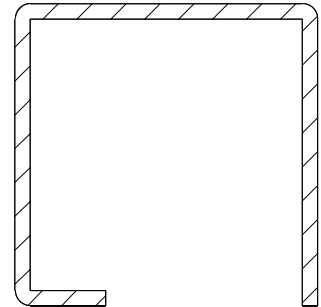

287787 - 40 x 40 x 40 x 12

Pre-routed 287789 - 40 x 40 x 40 x 12

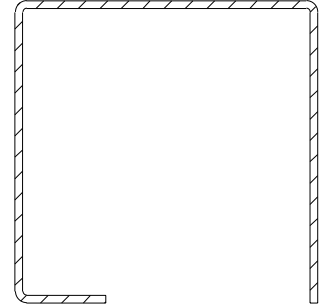

258841 - 40 x 40 (welded)

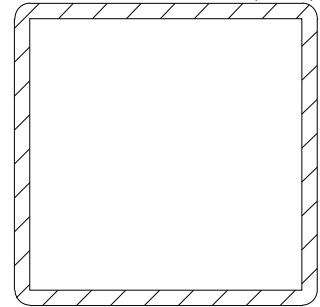

200374 - 40 x 40

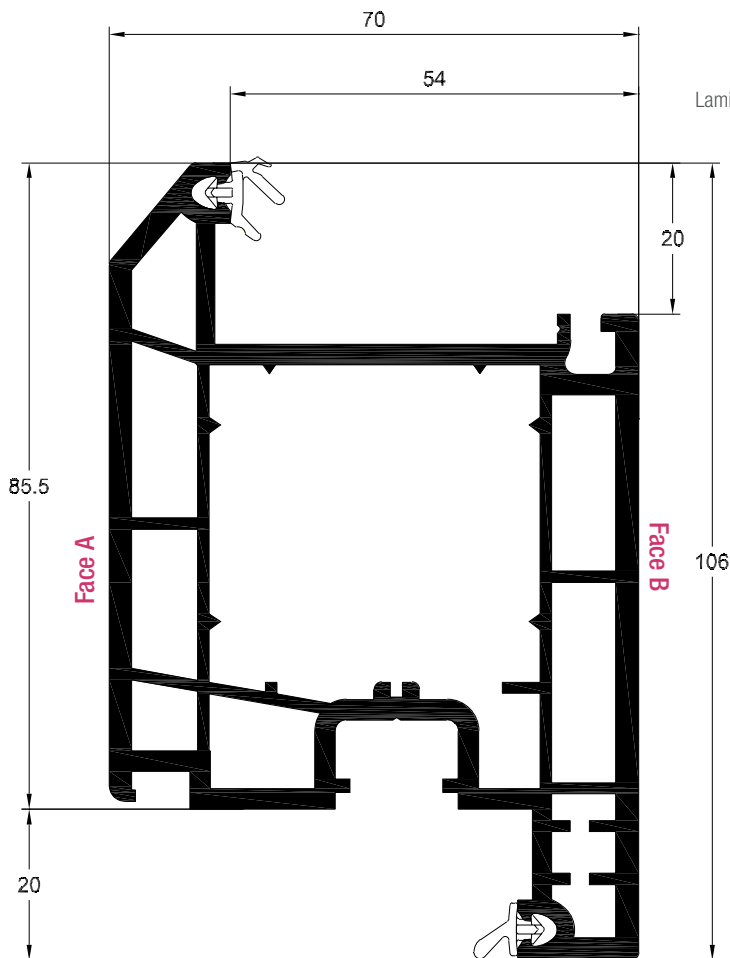
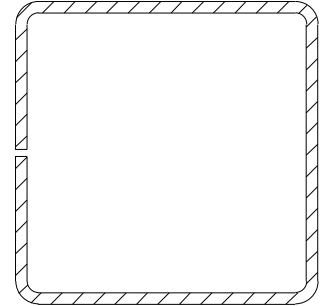

Door Z Sash 105.5mm
 White Profile Art. No. 546625
 Laminated Profile Art. No. 576625

REHAU TOTAL70c

TRANSOM / MULLIONS

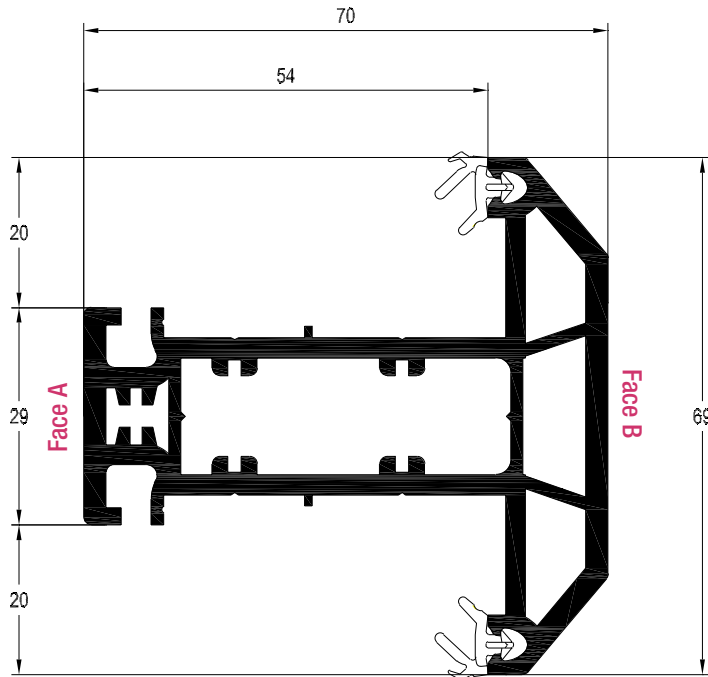

Slim Transom / Mullion T 69mm
 White Profile Art. No. 546085
 Laminated Profile Art. No. 576265

	261748	249838	261948
	2mm	1mm	Aluminium
ix	3.06	1.77	4.18
ly	0.27	0.14	0.3

261748 - 42 x 10

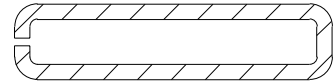

249838 - 42 x 10



261948 - 42 x 10

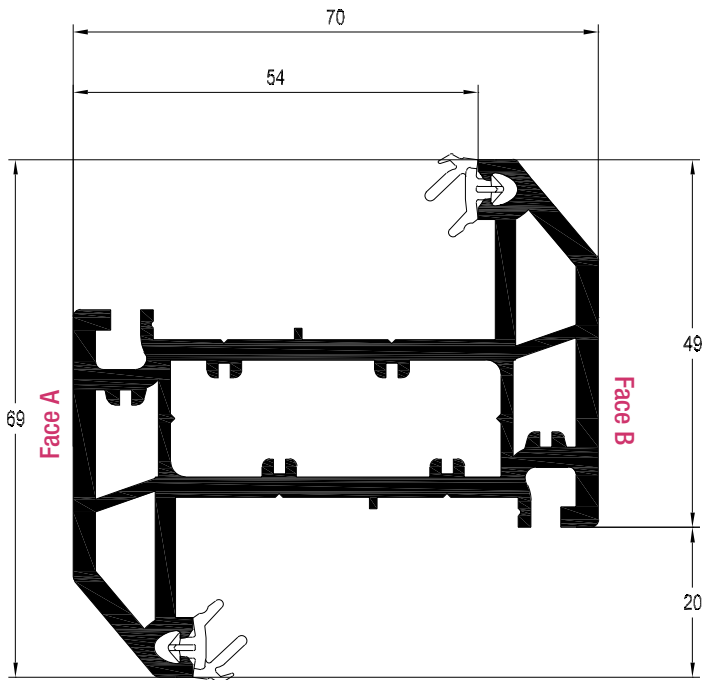
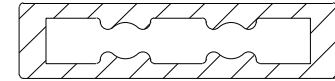

Slim Transom / Mullion Z 69mm
 White Profile Art. No. 546095
 Laminated Profile Art. No. 576275

	261748	249838	261948
	2mm	1mm	Aluminium
ix	3.06	1.77	4.18
ly	0.27	0.14	0.3

261748 - 42 x 10

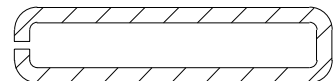

249838 - 42 x 10

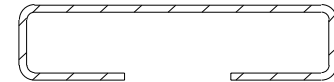

261948 - 42 x 10

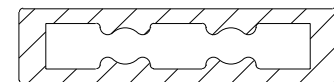

REHAU TOTAL70c

TRANSOM / MULLIONS

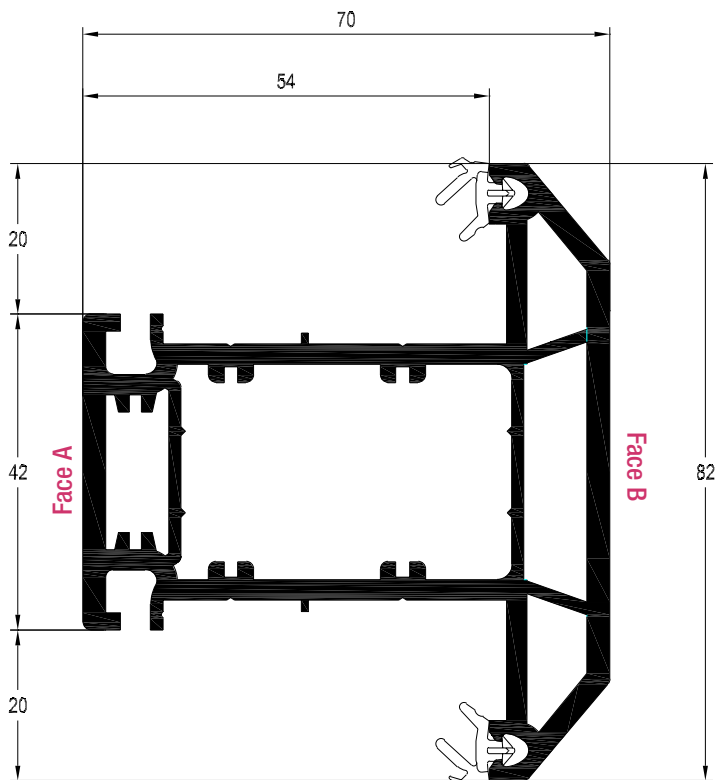

Large Transom / Mullion T 82mm
 White Profile Art. No. 546475
 Laminated Profile Art. No. 576026

	261738	287776	200347
	2.5mm	2mm	2.5mm
lx	6.06	5.14	4.70
ly	2.33	2.0	2.11

261738 - 42 x 23

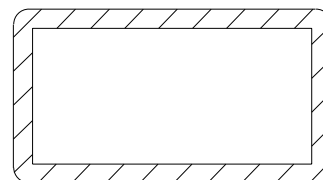

287776 - 42 x 23

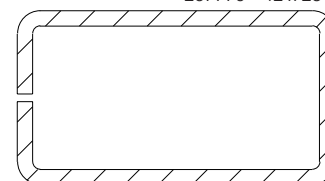

200347 - 42 x 30 x 23

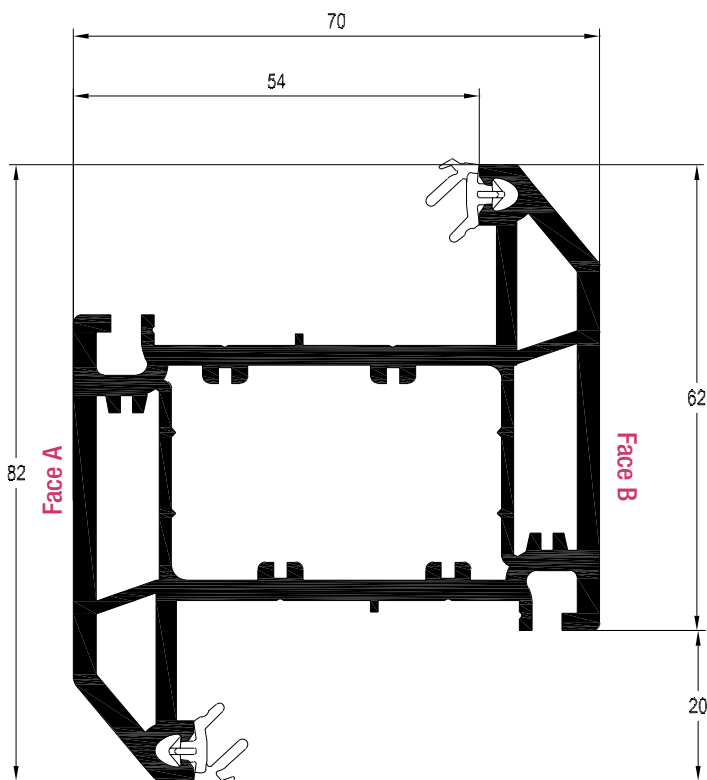
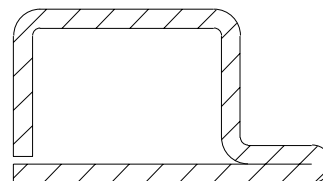

Large Transom / Mullion Z 82mm
 White Profile Art. No. 546465
 Laminated Profile Art. No. 576046

	261738	287776
	2.5mm	2mm
lx	6.06	5.14
ly	2.33	2.0

261738 - 42 x 23

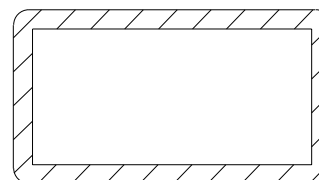

287776 - 42 x 23

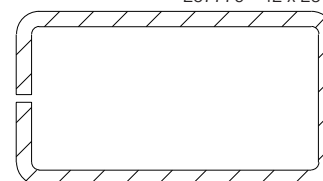

REHAU TOTAL70c

GLAZING BEADS

FOR SINGLE GLAZING

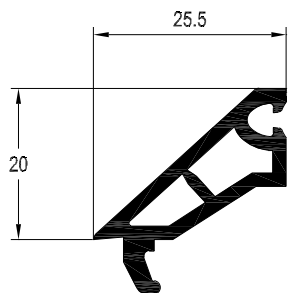

Non Co-extruded Glazing Bead 25.5mm
White Art. No. 546110
Laminated Art. No. 576290*

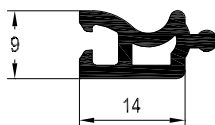

Adapter Bead
White Art. No. 546310
Condensation Adapter Bead 2

FOR 20MM SEALED UNITS

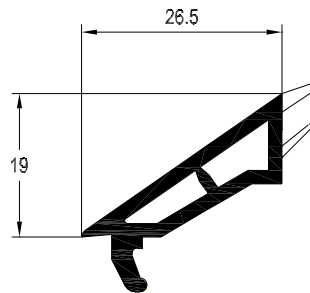

Co-extruded Glazing Bead 26.5mm
White Art. No. 546150
Laminated Art. No. 576330

FOR 24MM SEALED UNITS

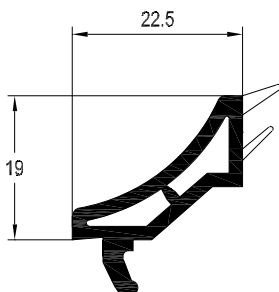

Co-extruded Glazing Bead 22.5mm
White Art. No. 561450
Laminated Art. No. 576550*

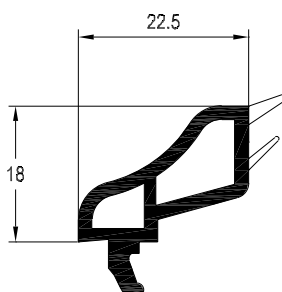

Co-extruded Glazing Bead 22.5mm
White Art. No. 551510
Laminated Art. No. 581580

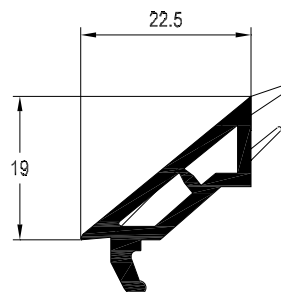

Co-extruded Glazing Bead 22.5mm
White Art. No. 546140
Laminated Art. No. 576320

FOR 28MM SEALED UNITS

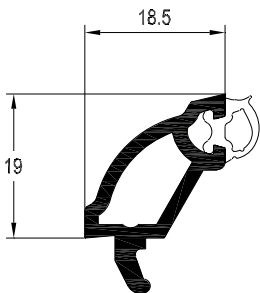

Co-extruded Glazing Bead 18.5mm
White Art. No. 546572
Laminated Art. No. 576572

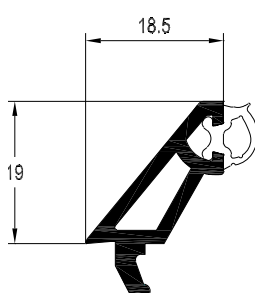

Co-extruded Glazing Bead 18.5mm
White Art. No. 546132
Laminated Art. No. 576132

FOR 32MM SEALED UNITS

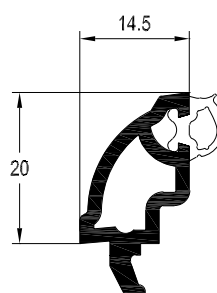

Co-extruded Glazing Bead 14.5mm
White Art. No. 503681
Laminated Art. No. 573679*

FOR 36MM SEALED UNITS

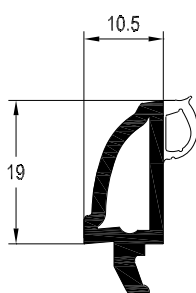

Co-extruded Glazing Bead 10.5mm
White Art. No. 503720
Laminated Art. No. 573720*

FOR 44MM SEALED UNITS



Co-extruded Glazing Bead 7.8mm
White Art. No. 546860
Laminated Art. No. 586865

FOR EXTERNAL GLAZING

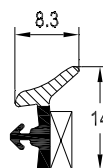

Glazing Seal
Art. No. 576130
RAUSECUR
Security Gasket - Black

Article Number	Variant Number	Description	Finish	Quantity (metres)	Packaging	Colour	
						White	Other
200022	001	Reinforcement 30 x 23 x 17 x 16 x 35 x 2mm	Steel	6	Length		*
200327	001	Reinforcement 42 x 30 x 30 x 18 x 1.5mm	Steel	6	Length		*
200347	001	Reinforcement 42 x 30 x 23 x 2.5mm	Steel	6	Length		*
200374	001	Reinforcement 40 x 40 x 1.5mm	Steel	6	Length		*
216391	001	Reinforcement 25 x 11 x 1.5mm	Steel	6	Length		*
216392	001	Reinforcement 25 x 21 x 1.5mm	Steel	6	Length		*
216393	001	Reinforcement 25 x 31 x 1.5mm	Steel	6	Length		*
216394	001	Reinforcement 30 x 23 x 1.5mm	Steel	6	Length		*
232822	001	Reinforcement 42 x 9.8 x 2mm	Steel	6	Length		*
249838	001	Reinforcement 42 x 10 x 1mm	Steel	6	Length		*
249848	001	Reinforcement 42 x 30 x 1mm	Steel	6	Length		*
252827	003	Reinforcement 40 x 40 x 40 x 12 x 2mm	Steel	6	Length		*
258841	003	Reinforcement 40 x 40 x 2mm (welded)	Steel	6	Length		*
261738	001	Reinforcement 42 x 23 x 2.5mm	Steel	6	Length		*
261748	001	Reinforcement 42 x 10 x 2mm	Steel	6	Length		*
261938*	001	Reinforcement 15 x 35 x 13 x 19 x 1.5mm	Steel	6	Length		*
261948	001	Reinforcement 42 x 10	Aluminium	6	Length		*
261958	001	Reinforcement 42 x 30 x 1.5mm	Steel	6	Length		*
261968*	001	Reinforcement 20 x 35 x 20 x 19 x 1.5mm	Steel	6	Length		*
262490	001	Reinforcement 40 x 40 40 x 12 x 2mm (pre-routed)	Steel	2.2	Length		*
287776	001	Reinforcement 42 x 23 x 2mm	Steel	6	Length		*
287777	001	Reinforcement 20 x 35 x 20 x 19 x 1mm	Steel	6	Length		*
287779	001	Reinforcement 18 x 40 x 18 x 1mm	Steel	6	Length		*
287786	001	Reinforcement 15 x 35 x 14 x 19 x 1mm	Steel	6	Length		*
287787	001	Reinforcement 40 x 40 x 40 x 12 x 1mm	Steel	6	Length		*
287789	001	Reinforcement 40 x 40 x 40 x 12 x 1mm (pre-routed)	Steel	2.2	Length		*
503681	701 / 705 / 715	Co-extruded Glazing Bead 14.5mm	White	144	Pack	*	
503720	701 / 705 / 715	Co-extruded Glazing Bead 10.5mm	White	144	Pack	*	
546066	701	Casement Z Sash	White	36	Pack	*	
546075	701 / 901	Casement Slim Outer Frame 52mm	White	48 / 768	Pack / Stillage	*	
546085	701 / 901	Slim Transom / Mullion T 69mm	White	36 / 624	Pack / Stillage	*	
546095	701 / 901	Slim Transom / Mullion Z 69mm	White	36 / 624	Pack / Stillage	*	
546106	701 / 901	Casement T Sash 75mm	White	36 / 576	Pack / Stillage	*	
546110	701	Non Co-extruded Glazing Bead 25.5mm	White	144	Pack	*	
546132	701 / 705 / 715	Co-extruded Glazing Bead 18.5mm	White	144	Pack	*	
546140	701	Co-extruded Glazing Bead 22.5mm	White	144	Pack	*	

Article Number	Variant Number	Description	Finish	Quantity (metres)	Packaging	Colour	
						White	Other
546150	701	Co-extruded Glazing Bead 26.5mm	White	144	Pack	*	
546185	701 / 901	Casement Universal Outer Frame 72mm	White	36 / 480	Pack / Stillage	*	
546310	701	Condensation Adapter Bead	White	144	Pack	*	
546465	701	Large Transom / Mullion Z 82mm	White	26	Pack	*	
546475	701	Large Transom / Mullion T 82mm	White	39	Pack	*	
546572	701 / 705 / 715	Co-extruded Glazing Bead 18.5mm	White	144	Pack	*	
546586	701 / 901	Part Sculptured Casement T Sash 75mm	White	36 / 576	Pack / Stillage	*	
546605	701 / 901	Casement Intermediate Outer Frame 62mm	White	36 / 576	Pack / Stillage	*	
546625	701 / 901	Door Z Sash 105.5mm	White	24 / 336	Pack / Stillage	*	
546635	701 / 901	Door T Sash / Midrail 105.5mm	White	24 / 336	Pack / Stillage	*	
546760	701 / 053	Composite Door Outer Frame	White	36 / 21.2	Pack / Pack	*	
546776	701 / 901	Tilt and Turn Sash 70mm	White	36 / 624	Pack / Stillage	*	
546815	701 / 901	Casement Slim Outer Frame 52mm (5 Chamber)	White	24 / 768	Pack / Stillage	*	
546825	701 / 901	Casement Intermediate Outer Frame 62mm (5 Chamber)	White	24 / 576	Pack / Stillage	*	
546835	701 / 901	Casement Universal Outer Frame 72mm (5 Chamber)	White	24 / 480	Pack / Stillage	*	
546845	701	Casement Slim Outer Frame 52mm (6 Chamber)	White	24	Pack	*	
546855	701 / 901	Casement T Sash 75mm (5 chamber)	White	24 / 576	Pack / Stillage	*	
546860	701 / 705 / 715	Co-extruded Glazing Bead 7.8mm	White	144	Pack	*	
551510	701	Co-extruded Glazing Bead 22.5mm	White	144	Pack / Stillage	*	
561450	001	Co-extruded Glazing Bead 22.5mm	White	144	Pack / Stillage	*	
576026	751 / 721 / 761	Large Transom / Mullion T 82mm	Mahogany	39	Pack		*
576026	251 / 221 / 261	Large Transom / Mullion T 82mm	Rosewood	39	Pack		*
576026	351 / 321 / 361	Large Transom / Mullion T 82mm	Golden Oak	39	Pack		*
576046	751 / 721 / 761	Large Transom / Mullion Z 82mm	Mahogany	26	Pack		*
576046	251 / 221 / 261	Large Transom / Mullion Z 82mm	Rosewood	26	Pack		*
576046	351 / 321 / 361	Large Transom / Mullion Z 82mm	Golden Oak	26	Pack		*
576130	002	Security Gasket	Black	400	Spool		*
576132	751	Co-extruded Glazing Bead 18.5mm	Mahogany	144	Pack		*
576132	790	Co-extruded Glazing Bead 18.5mm	Golden Oak	144	Pack		*
576132	251	Co-extruded Glazing Bead 18.5mm	Rosewood	144	Pack		*
576247	751 / 721	Casement Z Sash	Mahogany	36	Pack		*
576247	251 / 221	Casement Z Sash	Rosewood	36	Pack		*
576247	351 / 321	Casement Z Sash	Golden Oak	36	Pack		*
576255	751 / 721 / 761	Casement Slim Outer Frame 52mm	Mahogany	48	Pack		*
576255	251 / 221 / 261	Casement Slim Outer Frame 52mm	Rosewood	48	Pack		*

Article Number	Variant Number	Description	Finish	Quantity (metres)	Packaging	Colour	
						White	Other
576255	351 / 321 / 361	Casement Slim Outer Frame 52mm	Golden Oak	48	Pack		*
576265	751 / 721 / 761	Slim Transom / Mullion T 69mm	Mahogany	36	Pack		*
576265	251 / 221 / 261	Slim Transom / Mullion T 69mm	Rosewood	36	Pack		*
576265	351 / 321 / 361	Slim Transom / Mullion T 69mm	Golden Oak	36	Pack		*
576267	751 / 721 / 761	Part Sculptured Casement T Sash 75mm	Mahogany	36	Pack		*
576267	251 / 221 / 261	Part Sculptured Casement T Sash 75mm	Rosewood	36	Pack		*
576267	351 / 321 / 361	Part Sculptured Casement T Sash 75mm	Golden Oak	36	Pack		*
576275	751 / 721	Slim Transom / Mullion Z 69mm	Mahogany	36	Pack		*
576275	251 / 221	Slim Transom / Mullion Z 69mm	Rosewood	36	Pack		*
576275	351 / 321	Slim Transom / Mullion Z 69mm	Golden Oak	36	Pack		*
576286	751 / 721 / 761	Casement Intermediate Outer Frame 62mm	Mahogany	36	Pack		*
576286	251 / 221 / 261	Casement Intermediate Outer Frame 62mm	Rosewood	36	Pack		*
576286	351 / 321 / 361	Casement Intermediate Outer Frame 62mm	Golden Oak	36	Pack		*
576287	751 / 721 / 761	Casement T Sash 75mm	Mahogany	36	Pack		*
576287	251 / 221 / 261	Casement T Sash 75mm	Rosewood	36	Pack		*
576287	351 / 321 / 361	Casement T Sash 75mm	Golden Oak	36	Pack		*
576320	751	Co-extruded Glazing Bead 22.5mm	Mahogany	144	Pack		*
576320	251	Co-extruded Glazing Bead 22.5mm	Rosewood	144	Pack		*
576320	351	Co-extruded Glazing Bead 22.5mm	Golden Oak	144	Pack		*
576330	251	Co-extruded Glazing Bead 26.5mm	Rosewood	72	Pack		*
576365	751 / 721 / 761	Casement Universal Outer Frame 72mm	Mahogany	36	Pack		*
576365	251 / 221 / 261	Casement Universal Outer Frame 72mm	Rosewood	36	Pack		*
576365	351 / 321 / 361	Casement Universal Outer Frame 72mm	Golden Oak	36	Pack		*
576572	751	Co-extruded Glazing Bead 18.5mm	Mahogany	144	Pack		*
576572	251 / 270	Co-extruded Glazing Bead 18.5mm	Rosewood	144	Pack		*
576572	790 / 351	Co-extruded Glazing Bead 18.5mm	Golden Oak	144	Pack		*
576625	751 / 721	Door Z Sash 105.5mm	Mahogany	24	Pack		*
576625	251 / 221	Door Z Sash 105.5mm	Rosewood	24	Pack		*
576625	351 / 321	Door Z Sash 105.5mm	Golden Oak	24	Pack		*
576635	751 / 721 / 761	Door T Sash / Midrail 105.5mm	Mahogany	24	Pack		*
576635	251 / 221 / 261	Door T Sash / Midrail 105.5mm	Rosewood	24	Pack		*
576635	351 / 321 / 361	Door T Sash / Midrail 105.5mm	Golden Oak	24	Pack		*
576761	751 / 761	Composite Door Outer Frame	Mahogany	36	Pack		*
576761	251 / 221 / 261	Composite Door Outer Frame	Rosewood	36	Pack		*
576761	351 / 321 / 361	Composite Door Outer Frame	Golden Oak	36	Pack		*

Article Number	Variant Number	Description	Finish	Quantity (metres)	Packaging	Colour	
						White	Other
576776	751 / 721	Tilt and Turn Sash 70mm	Mahogany	36	Pack		*
576776	251 / 221	Tilt and Turn Sash 70mm	Rosewood	36	Pack		*
576776	351 / 321	Tilt and Turn Sash 70mm	Golden Oak	36	Pack		*
581580	751	Co-extruded Glazing Bead 22.5mm	Mahogany	144	Pack		*
581580	302	Co-extruded Glazing Bead 22.5mm	Rosewood	144	Pack		*
581580	790	Co-extruded Glazing Bead 22.5mm	Golden Oak	144	Pack		*
586815	751 / 721 / 761	Casement Slim Outer Frame 52mm (5 Chamber)	Mahogany	12	Pack		*
586815	251 / 221 / 261	Casement Slim Outer Frame 52mm (5 Chamber)	Rosewood	12	Pack		*
586815	351 / 321 / 361	Casement Slim Outer Frame 52mm (5 Chamber)	Golden Oak	12	Pack		*
586825	751 / 721 / 761	Casement Intermediate Outer Frame 62mm (5 Chamber)	Mahogany	12	Pack		*
586825	251 / 221 / 261	Casement Intermediate Outer Frame 62mm (5 Chamber)	Rosewood	12	Pack		*
586825	351 / 321 / 361	Casement Intermediate Outer Frame 62mm (5 Chamber)	Golden Oak	12	Pack		*
586835	751 / 721 / 761	Casement Universal Outer Frame 72mm (5 Chamber)	Mahogany	12	Pack		*
586835	251 / 221 / 261	Casement Universal Outer Frame 72mm (5 Chamber)	Rosewood	12	Pack		*
586835	351 / 321 / 361	Casement Universal Outer Frame 72mm (5 Chamber)	Golden Oak	12	Pack		*
586855	751 / 721 / 761	Casement T Sash 75mm (5 chamber)	Mahogany	12	Pack		*
586855	251 / 221 / 261	Casement T Sash 75mm (5 chamber)	Rosewood	12	Pack		*
586855	351 / 321 / 361	Casement T Sash 75mm (5 chamber)	Golden Oak	12	Pack		*
586865	751	Co-extruded Glazing Bead 7.8mm	Mahogany	144	Pack		*
586865	251	Co-extruded Glazing Bead 7.8mm	Rosewood	144	Pack		*
586865	790	Co-extruded Glazing Bead 7.8mm	Golden Oak	144	Pack		*
864610	009	Composite Door Gasket	Black	400	Roll		*
864610	010	Composite Door Gasket	Grey	400	Roll		*

REHAU TOTAL70c

NOTES

REHAU TOTAL70c

NOTES

REHAU TOTAL70c

NOTES

REHAU TOTAL70c Chamfered Profile Print



CHAMFERED
SYSTEM

UK & IRELAND SALES OFFICES

London, REHAU Ltd, The Building Centre, 25 Store Street, London WC1E 7BT Phone: 0207 580 6155 Fax: 0207 307 8595 **Slough**, Units 5 J & K, Langley Business Centre, Station Road, Langley, Slough SL3 8DS Phone: 01753 588500 Fax: 01753 588501 **Manchester**, Brinell Drive, Irlam, Manchester M44 5BL Phone: 0161 777 7400 Fax: 0161 777 7401 **Glasgow**, Phoenix House, Phoenix Crescent, Strathclyde Business Park, Bellshill, North Lanarkshire ML4 3NJ Phone: 01698 503700 Fax: 01698 503701 **Dublin**, 9 St. Johns Court, Business Park, Swords Road, Santry, Dublin 9 Phone: 00353 (0)1 8165020 Fax: 00353 (0)1 8165021

Our verbal and written application engineering advice is based upon experience and the best of our knowledge. However, it is to be regarded as non-binding information. Working conditions and use under conditions for which the product was not intended and over which we have no influence exclude any claim resulting from our information. We recommend that a check is made as to whether the REHAU product is suitable for the envisaged purpose. Application, use and processing of the products is carried out beyond the scope of our control and are therefore carried out exclusively at your own responsibility. If liability should still apply, then this is restricted, in the case of all damage, the value of the goods supplied by us and used by you.

Our warranty applies to the consistent quality of our products as per our specification and in accordance with our general terms and conditions of delivery and payment. This document is protected by copyright. All rights based on this are reserved. No part of this publication may be translated, reproduced or transmitted in any form or by any similar means, electronic or mechanical, photocopying, recording or otherwise, or stored in a data retrieval system.